

DOL starter, 7.5 kW Prepared for relay mounting  
 Contactor 3RT10, 230 V, 50 Hz Size S0, PE and N  
 terminal Molded-plastic enclosure IP65 Version for  
 Europe Button I-O (O=R), black/white

### General technical data:

<b>Design of the product</b>		direct starter
Adjustable pick-up value current of the current-dependent overload release	A	1.8 ... 17
Maximum short-circuit current breaking capacity (Icu) at 400 V rated value	kA	50
<b>Equipment marking acc. to DIN EN 61346-2</b>		K
<b>Equipment marking acc. to DIN 40719 extended according to IEC 204-2 acc. to IEC 750</b>		A

### Control circuit/ Control:

<b>Type of voltage</b>		AC
<b>Control supply voltage</b>		
<ul style="list-style-type: none"> <li>• at AC</li> <li>— at 50 Hz rated value</li> </ul>	V	230 ... 230
Supply voltage frequency for auxiliary and control current circuit rated value	Hz	50 ... 50
<b>Number of NC contacts for auxiliary contacts</b>		0
<b>Number of NO contacts for auxiliary contacts</b>		1
<b>Number of CO contacts for auxiliary contacts</b>		0

### Main circuit:

Operating voltage rated value	V	400
Operating current at AC at 400 V rated value	A	17
Operating power at AC-3 at 400 V rated value	kW	7.5
Product function Short circuit protection		No

### Mechanical data:

<b>Mounting type</b>		screw fixing
<b>Type of electrical connection for main current circuit</b>		screw-type terminals
Product component Motor brake output		No
Product function Bus communication		No
<b>Size of motor starter</b>		S0
<b>Width</b>	mm	105
<b>Height</b>	mm	190
<b>Depth</b>	mm	117

### Communication/ Protocol:

<b>Protocol is supported</b>		
• AS-interface protocol		No
• PROFIBUS DP protocol		No

#### Ambient conditions:

Ambient temperature during operation	°C	-20 ... +35
<b>Protection class IP</b>		IP65

#### Certificates/ approvals:

General Product Approval	Declaration of Conformity	Test Certificates	other
--------------------------	---------------------------	-------------------	-------



EG-Konf.

[Type Test Certificates/Test Report](#)

[Confirmation](#)

#### Further information

##### Information- and Downloadcenter (Catalogs, Brochures,...)

<http://www.siemens.com/industrial-controls/catalogs>

##### Industry Mall (Online ordering system)

<http://www.siemens.com/industrymall>

##### Cax online generator

<http://support.automation.siemens.com/WW/CAXorder/default.aspx?lang=en&mlfb=3RE1020-8XC25-0AP0>

##### Service&Support (Manuals, Certificates, Characteristics, FAQs,...)

<https://support.industry.siemens.com/cs/ww/en/ps/3RE1020-8XC25-0AP0>

##### Image database (product images, 2D dimension drawings, 3D models, device circuit diagrams, EPLAN macros, ...)

[http://www.automation.siemens.com/bilddb/cax\\_de.aspx?mlfb=3RE1020-8XC25-0AP0&lang=en](http://www.automation.siemens.com/bilddb/cax_de.aspx?mlfb=3RE1020-8XC25-0AP0&lang=en)

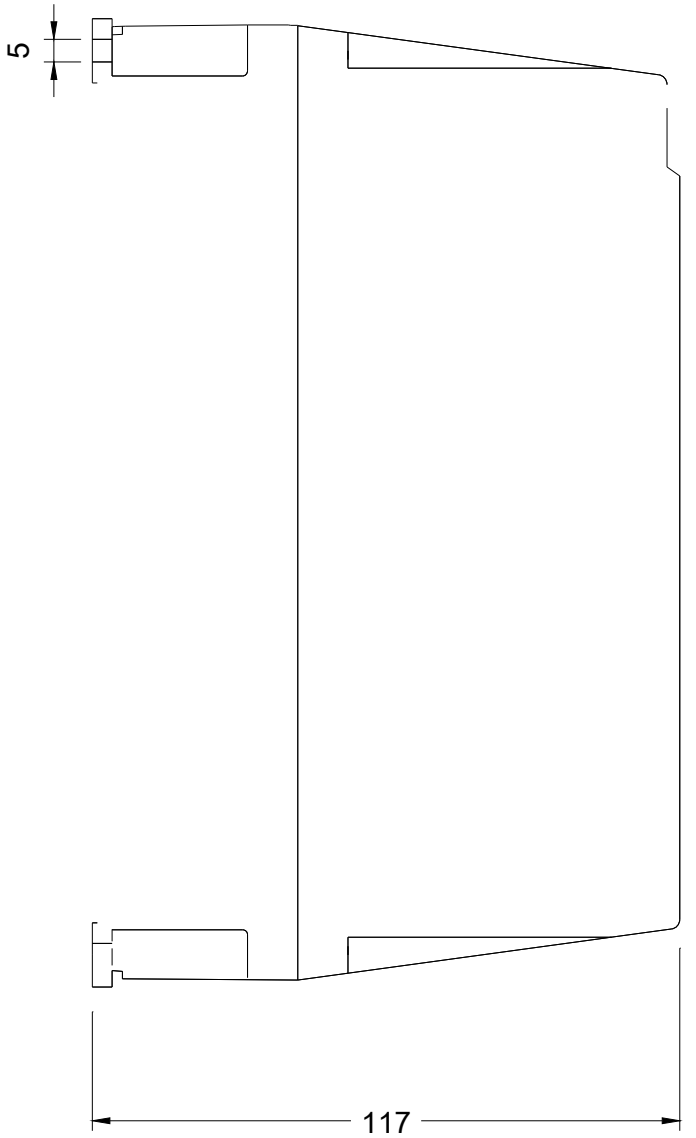
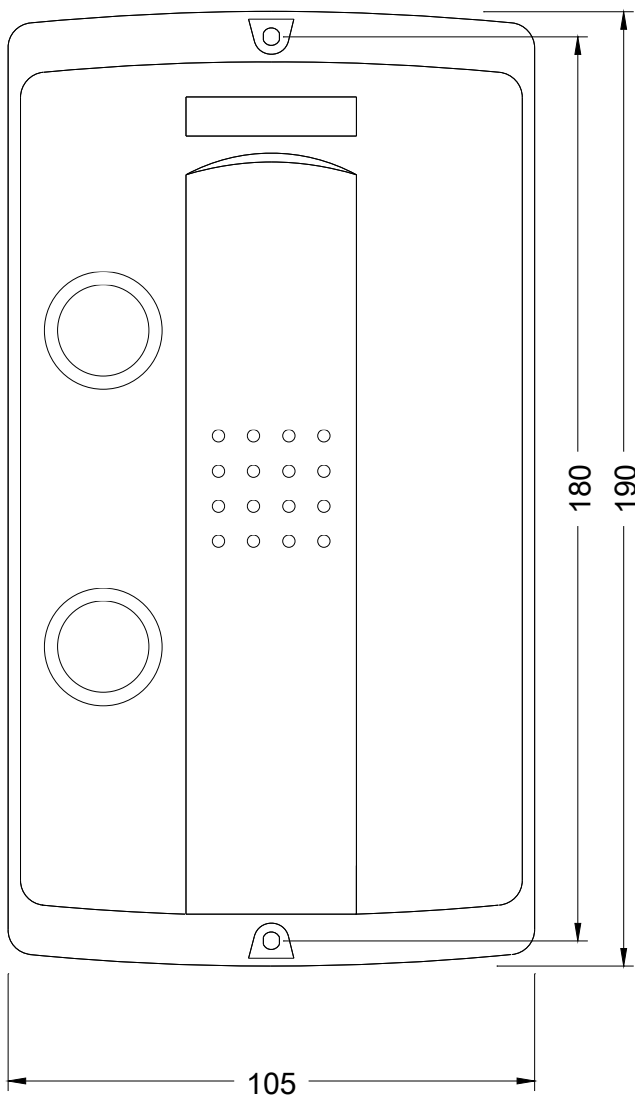

last modified:

08/03/2018